

PURE-FIXED GLASS PROCEDURE INSTALLATION

1. Check the correct positioning of the "gasket" on the external glazing. The gasket is the little rubber which is installed around the window. Replace if required.

Good position

Wrong position

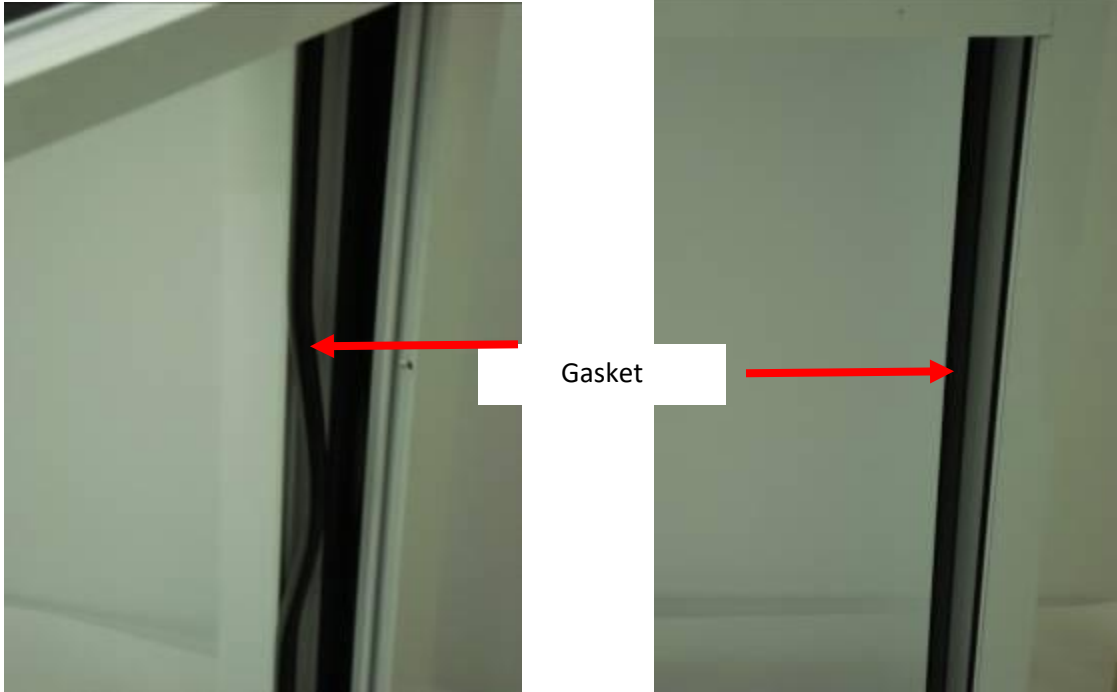

2. Lay 2 or 3 setting blocks (3 blocks if thermos over 30 PC) (1/2 "x 1" x 4 ") to the fixed window limit at 1/4 from the end. If the width of the window is smaller than 24 inches, install shims to 6 " from the end. Remove the plastic film adhesive on shims parts before installation.

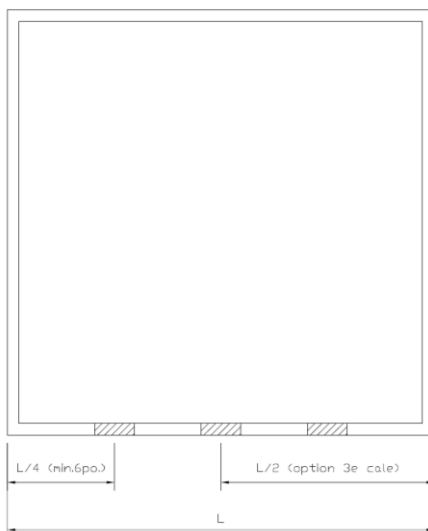

Here a setting block

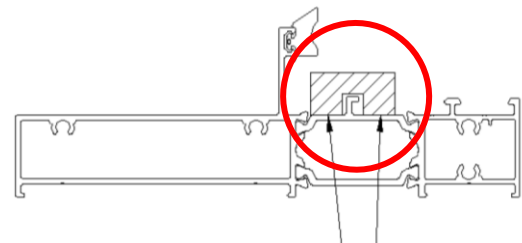

3. Fill the junction to the external glazing gaskets with black Adseal at the 4 corners before putting the thermo.

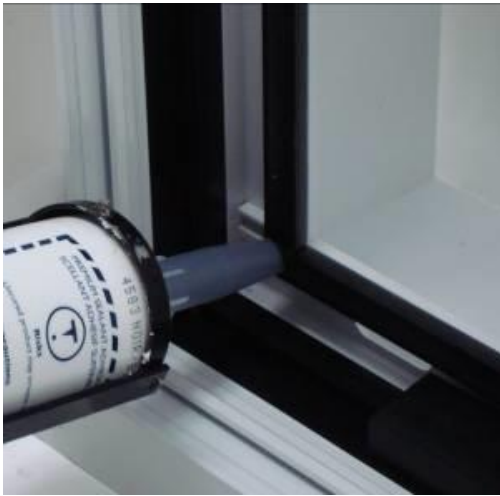

4. Install the thermo on setting blocks, and make sure it is leaning on the exterior glazing gasket before removing the wedges. Pay attention to the direction of the thermos. Normally, the arrows on the interlayer are pointed inward and the label must be found on the inside.

5. install the 5/8 width foam tubing on the perimeter of the thermo. The foam tubing must be cut to release the setting blocks. Insert the foam tubing alongside from the setting blocks first in a U-shape at the periphery of the window, leaving one inch free

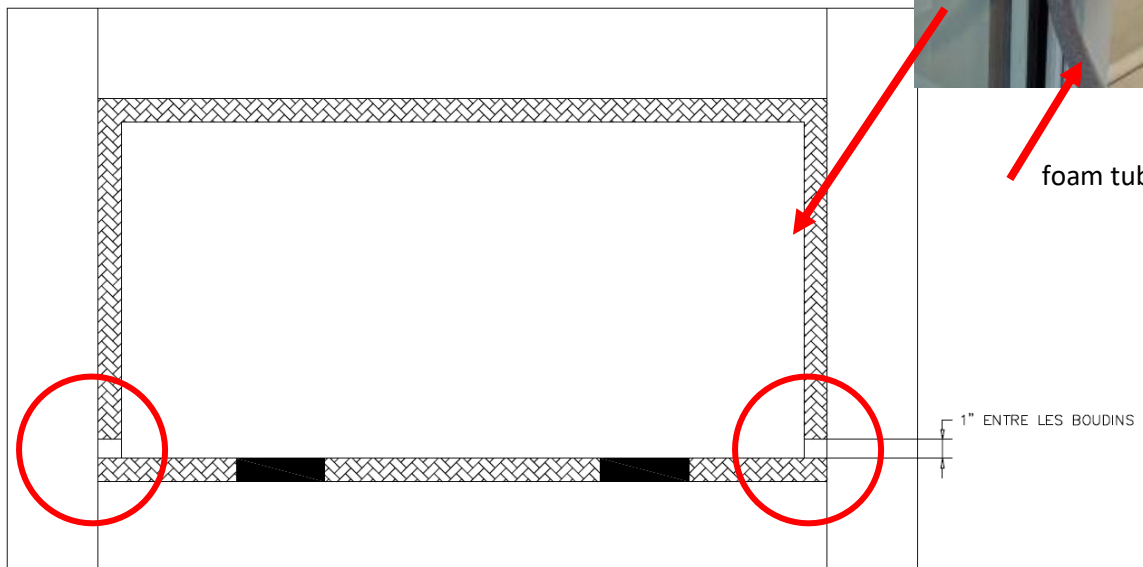

on each side.

6. Seal the top corners of the thermos on the frame on a length of 3 " on each side.

Seal in the shape of a U the bottom of the thermos on the frame to a length of 10 " with black Adseal.

Make sure you have contact with the glass thermos and aluminum frame.

IMPORTANT: pressure must be made on Adseal to ensure good adhesion to glass and aluminum to not having water infiltration.

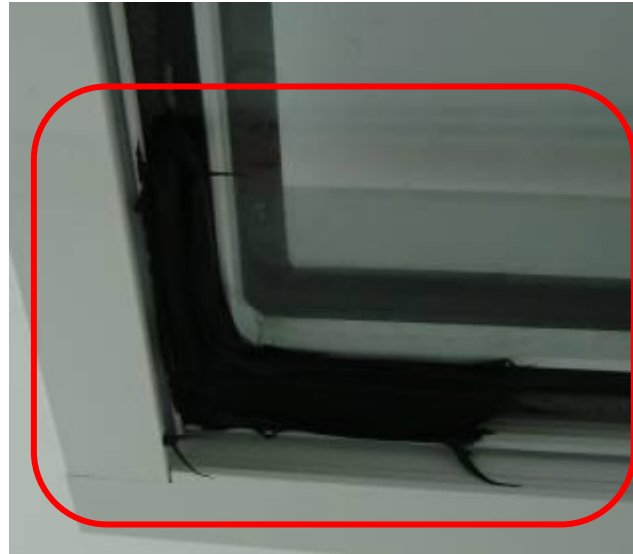
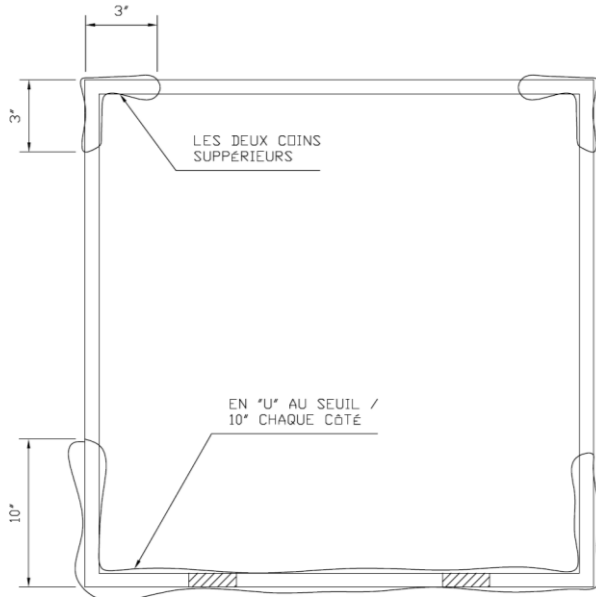

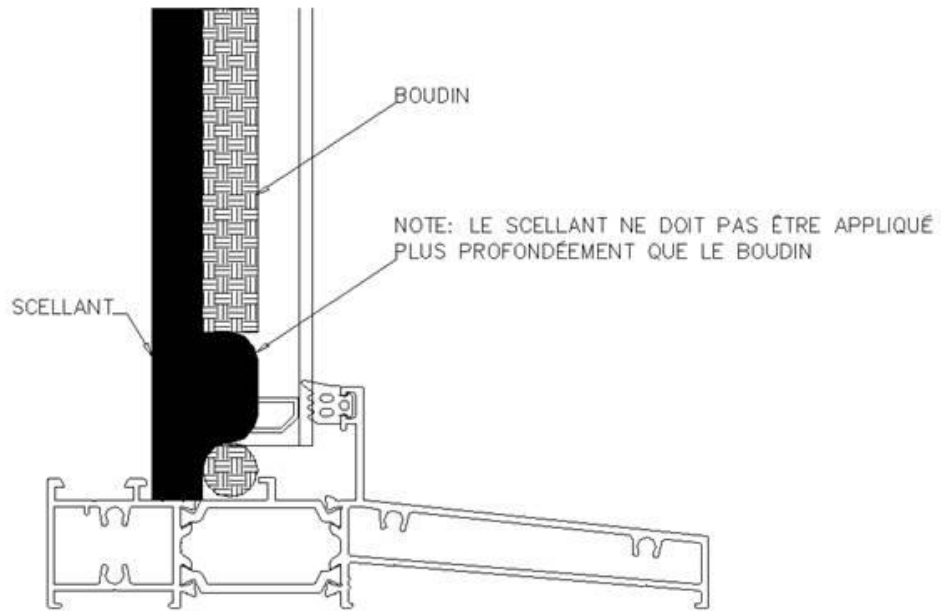

Ensure that the ADSEAL is not applied thicker than the tubing in order to ensure good drainage behind thereof.

7. Install thermo molding ensuring to clip the outer hook first (Threshold and head first).

The thermo molding can be tilted to the outside for better clipping.

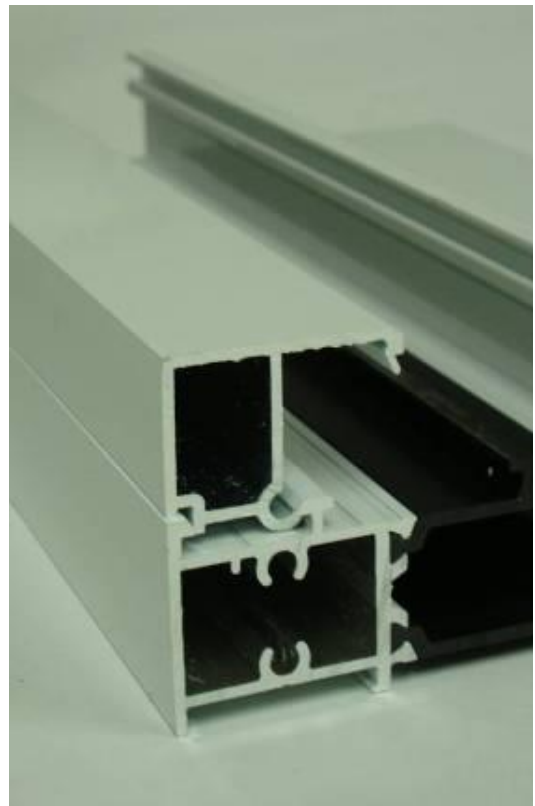
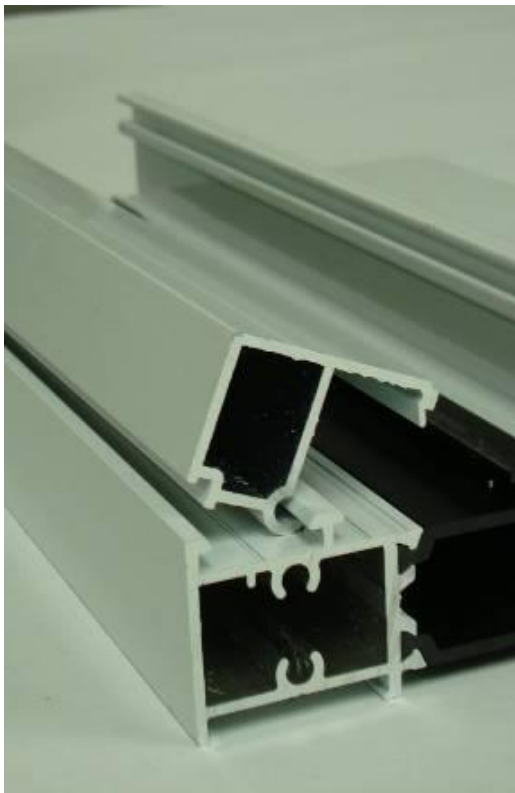
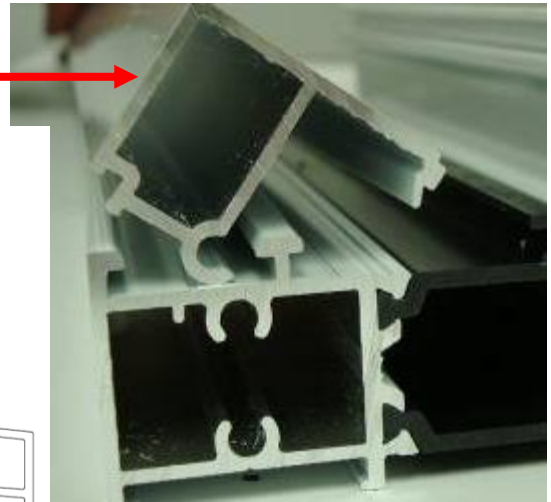
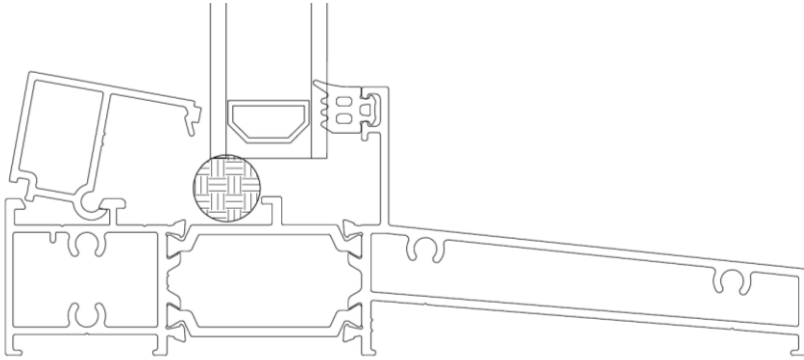

8. Install the glazing gasket inside the perimeter of the window by pushing it under the glazing beads. IF NECESSARY, use soapy water to facilitate insertion.

Measure 4 sides with glazing bead in glazing bead, and cut the gasket glazing by adding the length in the above table depending on what you just measure.

Example: if your measure between the glazing beads is 36 inches, you should cut your gasket to 36 1/2 inches.

INTERIOR GASKET	
Length. (in)	Add length
12 à 18	1/4 in
18 à 24	3/8 in
24 à 36	1/2 in
36 à 48	5/8 in
48 à 60	13/16 in
60 à 72	1 in
72 à 84	1-1/8 in
84 à 96	1-5/16 in
96 à 108	1-7/16 in
108 à 120	1-5/8 in
+ 120	1-13/16 in + 3/16in for 12 in additional

Then insert the gasket by pressing without cutting it in the end.

Gasket

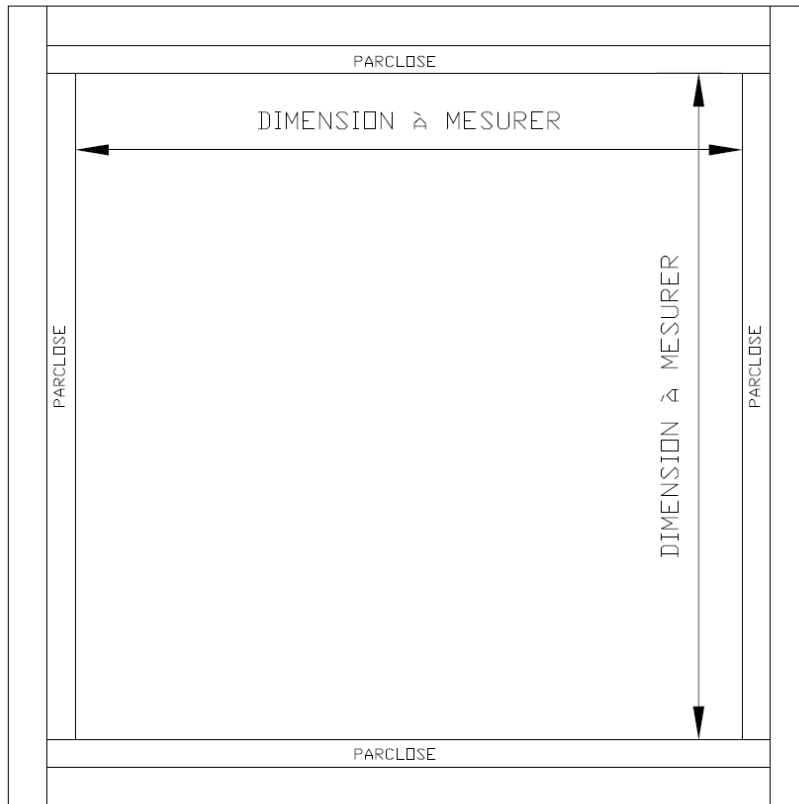

9. Seal surface at the junction of the thermo molding with Adseal, of the same color as the frame at the 4 corners.

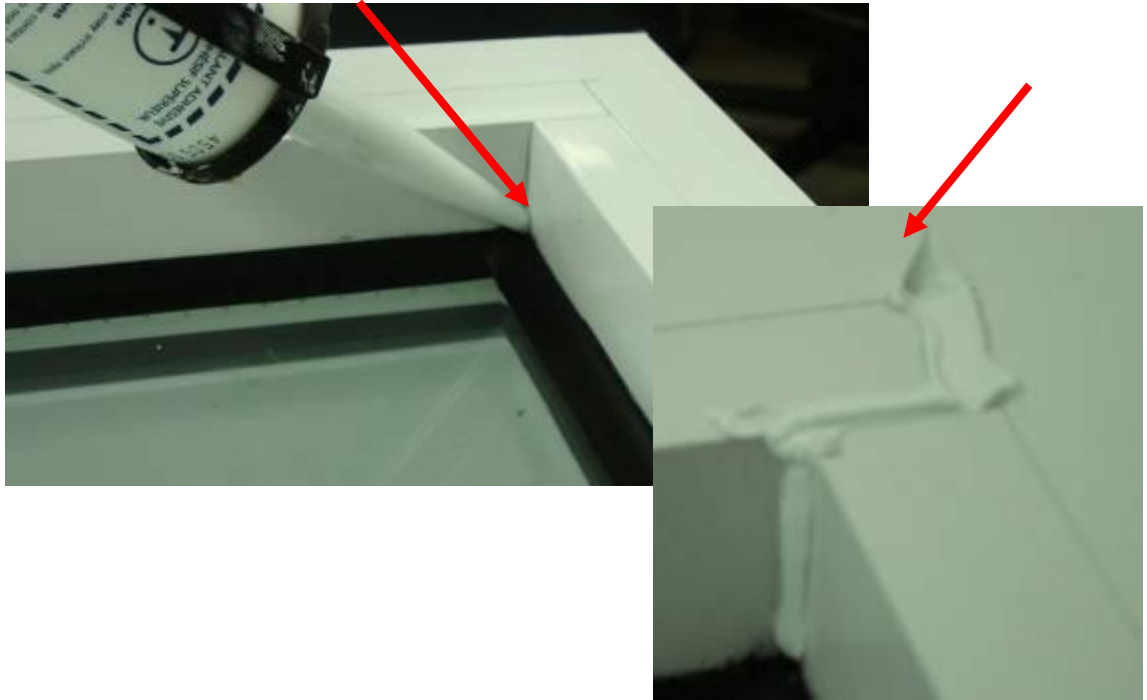

10. Clean excess lubricant and Adseal on the entire window (thermos included). Use naphtha for black products or special colors and Thinner for white and standard colors



For installation

**DO NOT USE CAULKING
BUTYL BY TREMCO**

* Not compatible with
our glass suppliers

